

Public Meeting

Area: North/Northwest **Address:** 8200 Wallingford Ave N
Project: 3018118 **Zone:** SINGLE FAMILY 5000, STEEP SLOPE ($\geq 40\%$), ARTERIAL WITHIN 100 FT.

Notice Date: 09/04/2014

Contact: EDWARD NOLAND - (206) 340-9500

Planner: John Shaw - (206) 684-5837

The Department of Planning and Development (DPD) is currently reviewing the application described below and will hold a public meeting to gather comments on the project.

Project Description: Land Use Application to install four 70-ft. tall light poles at Bishop Blanchet High School's athletic field. Review includes installation of a new Field Broadcast System.

The project requires the following approvals:

- Conditional Use
- Special Exception

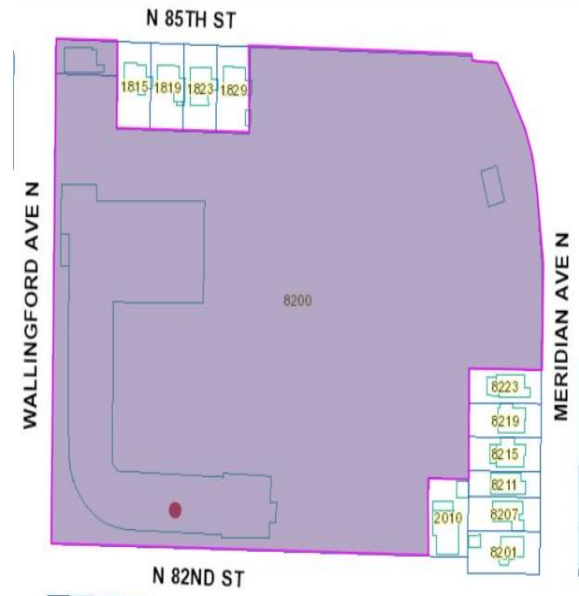

The top of this image is north.
This map is for illustrative purposes only. In the event of omissions, errors or differences, the documents in DPD's files will control.

INFORMATION AVAILABLE

Copies of the project application materials and plans are available in the DPD Electronic Library at <http://web6.seattle.gov/dpd/edms/> or at the DPD Public Resource Center, 700 5th Avenue, Suite 2000. The Public Resource Center is open 8:00 a.m. to 4:00 p.m. on Monday, Wednesday, Friday and 10:30 a.m. to 4:00 p.m. on Tuesday and Thursday. Questions may be directed to John Shaw, Senior Transportation Planner, DPD.

PUBLIC MEETING

A public meeting to review this application will be held **Monday, September 22, at the Phinney Ridge Community Center, 6532 Phinney Avenue N, at 6 PM.** Written and/or oral comments may be submitted at the meeting.

This facility is accessible. Print and communication access available on request. Please contact the Public Resource Center (206) 684-8467 as soon as possible to request accommodation for a disability.